

Polyamide en polyurethaan leiding

Voordelen polyamide leiding:

- Goede trilling bestendigheid
- Leidingen in verschillende kleuren verkrijgbaar voor gemakkelijke identificatie
- Goed schuur bestendig
- Lage druk val
- geen warmte uitzetting
- Goede chemische bestendigheid

Voordelen polyurethaan leiding:

- Zeer flexibel, heeft een buig radius die tot 3 keer beter is dan polyamide dat maakt dat deze slang ideaal is om te gebruiken in compacte ruimtes
- Leidingen in verschillende kleuren verkrijgbaar voor gemakkelijke identificatie
- Goede trilling bestendigheid
- Laag gewicht

Tube size	Minimum bend radius (mm)
3 x 0.60	15
4 x 0.65	20
4 x 1	20
5 x 1	35
6 x 1	35
8 x 1	45
10 x 1.25	60
10 x 1	60
12 x 1	10
14 x 1.50	85
16 x 1.50	95

Fluid	Working temperature		
	-20°C	+20°C	+60°C
Cutting oil	A	A	A
Cutting fluids	A	A	A
Water	A	A	A
Hydraulic oils	A	A	A
Mineral oils / greases	A	A	A
Carbon dioxide	A	A	A
Acetone	A	A	A
Gesolvo	B	B	B
Tetrachloroethylene	-	C	C

A = excellent, B = medium, C = poor
For other fluids please contact us

Fluid	Working temperature		
	-20°C	+20°C	+60°C
Cutting oil	A	A	A
Cutting fluids	A	A	A
Water	A	A	A
Hydraulic oils	A	A	A
Mineral oils / greases	A	A	A
Carbon dioxide	A	A	A
Gesolvo	B	B	B
Tetrachloroethylene	-	C	C
Acetone	-	C	C

Tube size	Minimum bend radius (mm)
3 x 0.5	13
4 x 0.75	17
5 x 1	22
6 x 1	27
8 x 1.25	37
10 x 1.50	54
12 x 2	67

Polyurethaanleidingen 25 m en 100 m

Leiding maat mm	Buiten dia. mm	Wand dikte mm	Kleur	Referentie 25 meter	Ca-nummer	Referentie 100 meter	CA-nummer
3 x 2	3	0,50	zwart	TPU3x0,5/5-25	76/96/2390	-	-
4 x 2,5	4	0,75	wit	1025U04 06	76/04/4598	-	-
4 x 2,5	4	0,75	blauw	TPU4x0,75/3-25	76/96/2400	-	-
4 x 2,5	4	0,75	zwart	TPU4x0,75/5-25	76/96/2405	-	-
5 x 3	5	1,00	zwart	1025U05 01	76/04/4599	-	-
6 x 4	6	1,00	wit	TPU6x1/1-25	76/96/2419	-	-
6 x 4	6	1,00	blauw	TPU6x1/3-25	76/96/2420	TPU6x1/3-100	76/96/2805
6 x 4	6	1,00	zwart	TPU6x1/5-25	76/96/2625	TPU6x1/5-100	76/96/2810
8 x 5,5	8	1,25	wit	TPU8x1,25/1-25	76/96/2429	-	-
8 x 5,5	8	1,25	blauw	TPU8x1,25/3-25	76/96/2430	TPU8x1,25/3-100	76/96/2815
8 x 5,5	8	1,25	rood	TPU8x1,25/2-25	76/96/2431	-	-
8 x 5,5	8	1,25	groen	TPU8x1,25/4-25	76/96/2433	-	-
8 x 5,5	8	1,25	zwart	TPU8x1,25/5-25	76/96/2435	TPU8x1,25/5-100	76/96/2820
10 x 7	10	1,50	wit	TPU10x1,5/1-25	76/96/2439	-	-
10 x 7	10	1,50	blauw	TPU10x1,5/3-25	76/96/2440	TPU10x1,5/3-100	76/96/2825
10 x 7	10	1,50	groen	TPU10x1,5/4-25	76/96/2443	-	-
10 x 7	10	1,50	zwart	TPU10x1,5/5-25	76/96/2445	TPU10x1,5/5-100	76/96/2830
12 x 8	12	2,00	wit	TPU12x2/1-25	76/96/2448	-	-
12 x 8	12	2,00	blauw	TPU12x2/3-25	76/96/2450	-	-
12 x 8	12	2,00	zwart	1025U12 01	76/04/4635	-	-
16 x 11	16	2,50	rood	TPU16x2,5/2-25	76/96/2460	-	-

* Andere afmetingen of kleuren op aanvraag

Leiding snijder



Referentie	CA-nummer
PTC	76/91/4000

Polyamideleidingen 25 m en 100 m

Leiding maat mm	Buiten dia. mm	Wand dikte mm	Kleur	Referentie 25 meter	Ca-nummer	Referentie 100 meter	CA-nummer
4 x 2	4	1,00	wit	1025P04C00	76/04/4509	1100P04C00	76/04/4516
4 x 2	4	1,00	zwart	1025P04C01	76/04/4507	1100P04C01	76/04/4518
4 x 2	4	1,00	groen	1025P04 02	76/04/4512	-	-
4 x 2	4	1,00	rood	1025P04 03	76/04/4513	-	-
4 x 2	4	1,00	blauw	1025P04C04	76/04/4508	1100P04C04	76/04/4506
4 x 2	4	1,00	geel	1025P04 05	76/04/4515	-	-
4 x 2,7	4	0,65	wit	1025P04 00 27	76/04/4500	-	-
4 x 2,7	4	0,65	zwart	1025P04 01 27	76/04/4501	-	-
4 x 2,7	4	0,65	groen	1025P04 02 27	76/04/4502	-	-
4 x 2,7	4	0,65	rood	1025P04 03 27	76/04/4503	-	-
4 x 2,7	4	0,65	blauw	1025P04 04 27	76/04/4504	-	-
4 x 2,7	4	0,65	geel	1025P04 05 27	76/04/4505	-	-
5 x 3,3	5	0,85	wit	1025P05 00 33	76/04/4521	-	-
5 x 3,3	5	0,85	zwart	1025P05 01 33	76/04/4522	-	-
5 x 3,3	5	0,85	blauw	1025P05 04 33	76/04/4523	-	-
6 x 4	6	1,00	wit	1025P06C00	76/04/4470	1100P06C00	76/04/4473
6 x 4	6	1,00	zwart	1025P06C01	76/04/4471	1100P06C01	76/04/4474
6 x 4	6	1,00	groen	1025P06 02	76/04/4526	-	-
6 x 4	6	1,00	rood	1025P06 03	76/04/4527	-	-
6 x 4	6	1,00	blauw	1025P06C04	76/04/4472	1100P06C04	76/04/4475
6 x 4	6	1,00	geel	1025P06 05	76/04/4529	-	-
8 x 6	8	1,00	wit	1025P08C00	76/04/4477	1100P08C00	76/04/4481
8 x 6	8	1,00	zwart	1025P08C01	76/04/4478	1100P08C01	76/04/4482
8 x 6	8	1,00	groen	1025P08 02	76/04/4538	1100P08 02	76/04/4545
8 x 6	8	1,00	rood	1025P08 03	76/04/4539	1100P08 03	76/04/4546
8 x 6	8	1,00	blauw	1025P08C04	76/04/4479	1100P08C04	76/04/4483
8 x 6	8	1,00	geel	1025P08 05	76/04/4541	-	-
10 x 8	10	1,00	wit	1025P10C00	76/04/4485	1100P10C00	76/04/4488
10 x 8	10	1,00	zwart	1025P10C01	76/04/4486	1100P10C01	76/04/4489
10 x 8	10	1,00	groen	1025P10 02	76/04/4550	-	-
10 x 8	10	1,00	rood	1025P10 03	76/04/4551	-	-
10 x 8	10	1,00	blauw	1025P10C04	76/04/4487	1100P10C04	76/04/4490
10 x 8	10	1,00	geel	1025P10 05	76/04/4553	-	-
12 x 10	12	1,00	wit	1025P12 00	76/04/4561	-	-
12 x 10	12	1,00	zwart	1025P12 01	76/04/4562	-	-
12 x 10	12	1,00	blauw	1025P12 04	76/04/4563	-	-
14 x 11	14	1,50	wit	1025P14 00 11	76/04/4567	-	-
14 x 11	14	1,50	zwart	1025P14 01 11	76/04/4568	-	-
14 x 11	14	1,50	blauw	1025P14 04 11	76/04/4569	-	-
16 x 13	16	1,50	wit	1025P16 00 13	76/04/4570	-	-

Technische gegevens:

- Materiaal:

- Maximale druk:

- Temperatuur weerstand:

Kunststof

Polyamide

16 bar

Van -25°C tot 70°C

Metaal

Vernikkeld messing

25 bar

Van -25°C tot 100°C

Rechte inschroef - BSPT - metaal

1	B	Model	CA-nummer
4	M5x0,8	F8PB4M5	76/91/0460
6	M5x0,8	F8PB6M5	76/91/0461
4	1/8"	F3PB4-1/8	76/91/0380
4	1/4"	F3PB4-1/4	76/91/0375
6	1/8"	F3PB6-1/8	76/91/0390
6	1/4"	F3PB6-1/4	76/91/0385
8	1/8"	F3PB8-1/8	76/91/0400
8	1/4"	F3PB8-1/4	76/91/0395
8	3/8"	F3PB8-3/8	76/91/0405
10	1/4"	F3PB10-1/4	76/91/0345
10	3/8"	F3PB10-3/8	76/91/0350
10	1/2"	F3PB10-1/2	76/91/0422
12	1/4"	F3PB12-1/4	76/91/0358
12	3/8"	F3PB12-3/8	76/91/0360
12	1/2"	F3PB12-1/2"	76/91/0355
14	3/8"	F3PB14-3/8	76/91/0370
14	1/2"	F3PB14-1/2	76/91/0365

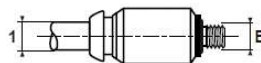
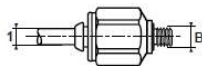

1	B	Model	CA-nummer
4	M5x0,8	F28PMB4M5	76/91/3195
6	M5x0,8	F28PMB6M5	76/91/3200

Rechte opschroef - BSPP - metaal

1	B	Model	CA-nummer
4	M5x0,8	G8PMB4M5	76/91/3310
4	1/8"	G4PB4-1/8	76/91/0465
4	1/4"	G4PMB4-1/4	76/91/3280
6	1/8"	G4PB6-1/8	76/91/0470
6	1/4"	G4PB6-1/4	76/91/0472
8	1/8"	G4PB8-1/8	76/91/0480
8	1/4"	G4PB8-1/4	76/91/0475

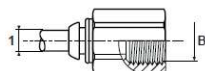

Compact haaks inschroef - BSPP - metaal

1	B	Model	CA-nummer
4	1/8"	C64SPB4-1/8	76/91/1055
6	1/8"	C64SPB6-1/8	76/91/1065
6	1/4"	C64SPB6-1/4	76/91/1060
8	1/8"	C64SPB8-1/8	76/91/1075
8	1/4"	C64SPB8-1/4	76/91/1070
8	3/8"	C64SPB8-3/8	76/91/1080
10	1/4"	C64SPB10-1/4	76/91/1035
10	3/8"	C64SPB10-3/8	76/91/1040
12	1/4"	C64SPB12-1/4	76/91/1045
12	3/8"	C64SPB12-3/8	76/91/1050
12	1/2"	C64SPB12-1/2	76/91/1052

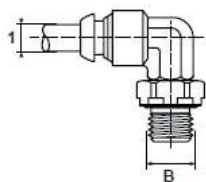

Haaks inschroef - BSPT - metaal

1	B	Model	CA-nummer
4	1/8"	C63PB4-1/8	76/91/0195
4	1/4"	C63PB4-1/4	76/91/0190
6	1/8"	C63PB6-1/8	76/91/0205
6	1/4"	C63PB6-1/4	76/91/0200
8	1/8"	C63PB8-1/8	76/91/0215
8	1/4"	C63PB8-1/4	76/91/0210
8	3/8"	C63PB8-3/8	76/91/0220
10	1/4"	C63PB10-1/4	76/91/0160
10	3/8"	C63PB10-3/8	76/91/0165
12	1/4"	C63PB12-1/4	76/91/0168
12	3/8"	C63PB12-3/8	76/91/0175

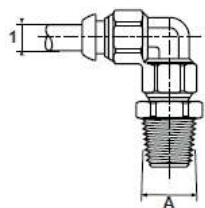

Haaks inschroef - BSPT - kunststof

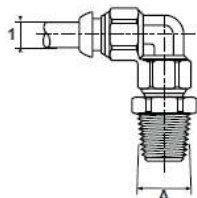

1	B	Model	CA-nummer
4	1/8"	3109 04 10	76/01/8500
4	1/4"	3109 04 13	76/01/8501
6	1/8"	3109 06 10	76/01/8504
6	1/4"	3109 06 13	76/01/8506
8	1/8"	3109 08 10	76/01/8508
8	1/4"	3109 08 13	76/01/8510
8	3/8"	3109 08 17	76/01/8512
10	1/4"	3109 10 13	76/01/8514
10	3/8"	3109 10 17	76/01/8516
12	1/4"	3109 12 13	76/01/8519
12	3/8"	3109 12 17	76/01/8517

Haaks lang inschroef - BSPT - metaal

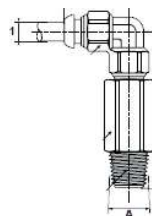

1	A	Model	CA-nummer
4	1/8"	C63LPB4-1/8	76/91/1010
4	1/4"	C63LPB4-1/4	76/91/1005
6	1/8"	C63LPB6-1/8	76/91/1020
6	1/4"	C63LPB6-1/4	76/91/1015

T- inschroef - BSPT - metaal

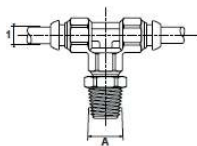

1	B	Model	CA-nummer
4	1/8"	S63PB4-1/8	76/91/0770
4	1/4"	S63PB4-1/4	76/91/0772
6	1/8"	S63PB6-1/8	76/91/0780
6	1/4"	S63PB6-1/4	76/91/0775
8	1/8"	S63PB8-1/8	76/91/0790
8	1/4"	S63PB8-1/4	76/91/0785
8	3/8"	S63PB8-3/8	76/91/0792
10	1/4"	S63PB10-1/4	76/91/0740
10	3/8"	S63PB10-3/8	76/91/0745
12	1/4"	S63PB12-1/4	76/91/0752
12	3/8"	S63PB12-3/8	76/91/0755

T- inschroef - BSPT - kunststof

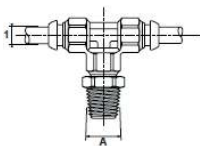

1	B	Model	CA-nummer
4	1/8"	3108 04 10	76/01/8402
4	1/4"	3108 04 13	76/01/8403
6	1/8"	3108 06 10	76/01/8404
6	1/4"	3108 06 13	76/01/8405
8	1/8"	3108 08 10	76/01/8406
8	1/4"	3108 08 13	76/01/8407
8	3/8"	3108 08 17	76/01/8408
10	1/4"	3108 10 13	76/01/8409
10	3/8"	3108 10 17	76/01/8410
12	1/4"	3108 12 13	76/01/8412
12	3/8"	3108 12 17	76/01/8413

Y- inschroef - BSPT - kunststof

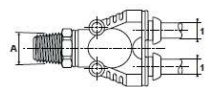

1	A	Model	CA-nummer
4	1/8"	3148 04 10	
4	1/4"	3148 04 13	
6	1/8"	3148 06 10	
6	1/4"	3148 06 13	
8	1/8"	3148 08 10	
8	1/4"	3148 08 13	

Buis-buiskoppeling - kunststof



1	Model	CA-nummer
4	3106 04 00	76/01/8300
6	3106 06 00	76/01/8308
8	3106 08 00	76/01/8312
10	3106 10 00	76/01/8316
12	3106 12 00	76/01/8317
14	3106 14 00	76/01/8318

Buis-buiskoppeling - metaal



1	Model	CA-nummer
4	HPB4	76/91/0500
6	HPB6	76/91/0505
8	HPB8	76/91/0510
10	HPB10	76/91/0485
12	HPB12	76/91/0490
14	HPB14	76/91/0495

Ongelijke buis-buiskoppeling - kunststof

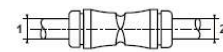

1	2	Model	CA-nummer
6	4	3106 04 06	76/01/8320
8	4	3106 04 08	76/01/8321
8	6	3106 06 08	76/01/8322
10	6	3106 06 10	76/01/8323
10	8	3106 08 10	76/01/8324
12	10	3106 10 12	76/01/8326

Buis-buis schotdoorvoerkoppeling - metaal

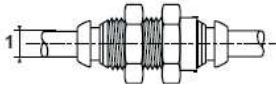

1	Model	CA-nummer
4	WPB4	76/91/0990
6	WPB6	76/91/0995
8	WPB8	76/91/1000
10	WPB10	76/91/0975
12	WPB12	76/91/0980

Buis-buis knie koppeling - metaal

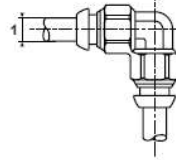

1	Model	CA-nummer
4	EPB4	76/91/0295
6	EPB6	76/91/0300
8	EPB8	76/91/0305
10	EPB10	76/91/0280
12	EPB12	76/91/0285
14	EPB14	76/91/0290

Buis-buis knie koppeling - kunststof

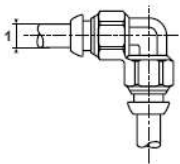

1	Model	CA-nummer
4	3102 04 00	76/01/8140
6	3102 06 00	76/01/8141
8	3102 08 00	76/01/8142
10	3102 10 00	76/01/8143
12	3102 12 00	76/01/8144
14	3102 14 00	76/01/8145

T-koppeling - kunststof

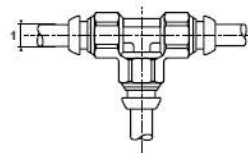

1	Model	CA-nummer
4	3104 04 00	76/01/8200
6	3104 06 00	76/01/8206
8	3104 08 00	76/01/8209
10	3104 10 00	76/01/8210
12	3104 12 00	76/01/8215
14	3104 14 00	76/01/8223

T-koppeling - metaal

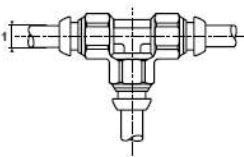

1	Model	CA-nummer
4	JPB4	76/91/0550
6	JPB6	76/91/0555
8	JPB8	76/91/0560
10	JPB10	76/91/0535
12	JPB12	76/91/0540
14	JPB14	76/91/0545

Reductie T-koppeling - kunststof

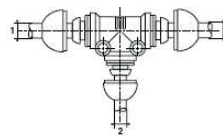

1	2	Model	CA-nummer
6	4	3104 06 04	76/01/8202
8	6	3104 08 06	76/01/8208
10	8	3104 10 08	76/01/8212
12	10	3104 12 10	76/01/8214
4	6	3104 04 06	76/01/8201
6	8	3104 06 08	76/01/8207
8	10	3104 08 10	76/01/8211
10	12	3104 10 12	76/01/8213

Multi T-koppeling - kunststof

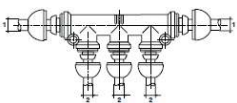

1	2	Model	CA-nummer
6	4	3304 06 04	76/02/3601
8	4	3304 08 04	76/02/3602
8	6	3304 08 06	76/02/3603
10	6	3304 10 06	76/02/3604

Reductie Y-koppeling - kunststof

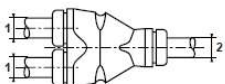

1	2	Model	CA-nummer
4	6	3140 04 06	76/02/0011
6	8	3140 06 08	76/02/0012
8	10	3140 08 10	

Y-koppeling - kunststof

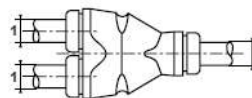

1	Model	CA-nummer
4	3140 04 00	76/02/0004
6	3140 06 00	76/02/0006
8	3140 08 00	76/02/0008
10	3140 10 00	

Reductie - metaal

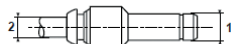

1	2	Model	CA-nummer
6	4	TRPB6-4	76/91/0915
8	4	TRPB8-4	76/91/0922
8	6	TRPB8-6	76/91/0925
10	4	TRPB10-4	76/91/0894
10	6	TRPB10-6	76/91/0895
10	8	TRPB10-8	76/91/0897
12	6	TRPB12-6	76/91/0898
12	8	TRPB12-8	76/91/0899
12	10	TRPB12-10	76/91/0900
14	8	TRPB14-8	76/91/0901
14	10	TRPB14-10	76/91/0902
14	12	TRPB14-12	76/91/0903

Reductie - kunststof



2	1	Model	CA-nummer
6	4	3166 04 06	76/02/0651
8	4	3166 04 08	76/02/0652
8	6	3166 06 08	76/02/0654
10	4	3166 04 10	76/02/0653
10	6	3166 06 10	76/02/0655
10	8	3166 08 10	76/02/0658
12	6	3166 06 12	76/02/0656
12	8	3166 08 12	76/02/0659
12	10	3166 10 12	76/02/0661
14	8	3166 08 14	76/02/0660
14	10	3166 10 14	76/02/0662
14	12	3166 12 14	76/02/0663

Vermeerdering - kunststof

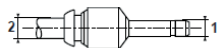

1	2	Model	CA-nummer
4	6	3168 06 04	76/02/0680

Haaks M/VR - kunststof

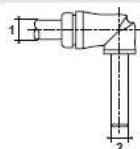

1	2	Model	CA-nummer
4	4	3182 04 00	76/02/1600
6	6	3182 06 00	76/01/1601
4	6	3182 04 06	
8	8	3182 08 00	76/02/1602

Plug - kunststof

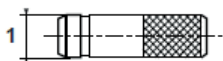

1	Model	CA-nummer
4	3126 04 00	76/01/9001
6	3126 06 00	76/01/9002
8	3126 08 00	76/02/9003
10	3126 10 00	76/01/9004
12	3126 12 00	76/01/9005
14	3126 14 00	76/01/9006

Banjokoppeling - metaal

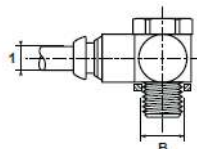

1	B	Model	CA-nummer
4	M5x0,8	COR8PB4M5	76/91/0096
4	1/8"	COR4PB4-1/8	76/91/0061
6	1/8"	COR4PB6-1/8	76/91/0071
6	1/4"	COR4PB6-1/4	76/91/0076
8	1/8"	COR4PB8-1/8	76/91/0091
8	1/4"	COR4PB8-1/4	76/91/0097
10	3/8"	COR4PB10-3/8	76/91/0098